

GD series

Static spray ball

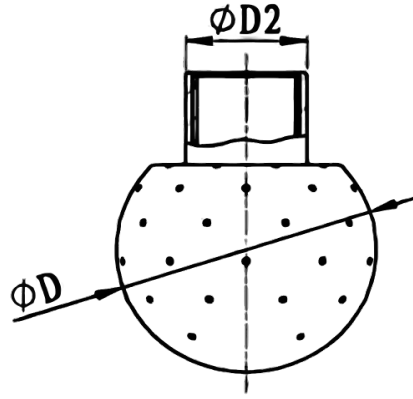

95-140°
TEMPERATURE



1-4 Bar
PRESSURE



Medium-large
TANKS



25-75mm
TANK OPENING



350°
SPRAY ANGLE



0.2-1mm
NOZZLE SIZE



19-325 l/m
FLOW RATE



1/8" - 1/2"
FR / BSPP FITTING



0.1 - 0.4
KILO GRAMS

DESIGN FEATURES

- 316LSS, 304SS and Hastelloy material
- Simple structure, no moving parts
- Low maintenance
- Uses steam and air
- Self-draining

SPRAY PATTERN

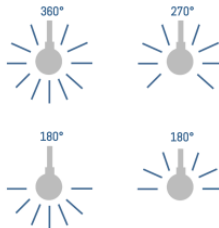

APPLICATION

- Food and beverage tanks
- Pharmaceutical industry tanks
- Small to medium tanks
- Large-flow rinsing
- Steam cleaning

Model	Flow rate (L/min)				Dimensions (mm)			Connection		
	2 Bar	3 Bar	4 Bar	5 Bar	D	D2	Min. tank openings	FR-BSPP thread (F)	AR-welding	TF-slip-on
GD25	19	23	27	30	25	12.7	25	1/8"-FR	1/2"-AR	1/2"-TF
GD30	22	27	31	35	30	12.7	30	1/8"-FR	1/2"-AR	1/2"-TF
GD40	27	37	43	48	40	19.05	40	1/4"-FR	3/4"-AR	3/4"-TF
GD45	64	80	92	103	45	19.05	45	1/2"-FR	3/4"-AR	3/4"-TF
GD50	76	100	108	121	50	25.4	50	1/2", 3/4" -FR	1"-AR	1"-TF
GD65	171	209.5	242	270	65	31.75	65	1"-FR	1-1/4"-AR	1-1/4"-TF
GD75	230	281	325	364	75	38.1	75	1-1/2"-FR	1-1/2"-AR	1-1-2"-TF

